



12 PYMORE ISLAND

PYMORE, DT6 5SD

£190,000
LEASEHOLD

A beautifully presented one bedroom penthouse apartment with spectacular views, located in the sought-after village of Pymore surrounded by wonderful countryside.

Vicary & Co
Chartered Surveyors & Property Agents

Estate Agents & Valuers
Residential - Commercial - Rural

Pymore, Bridport, DT6 5SD

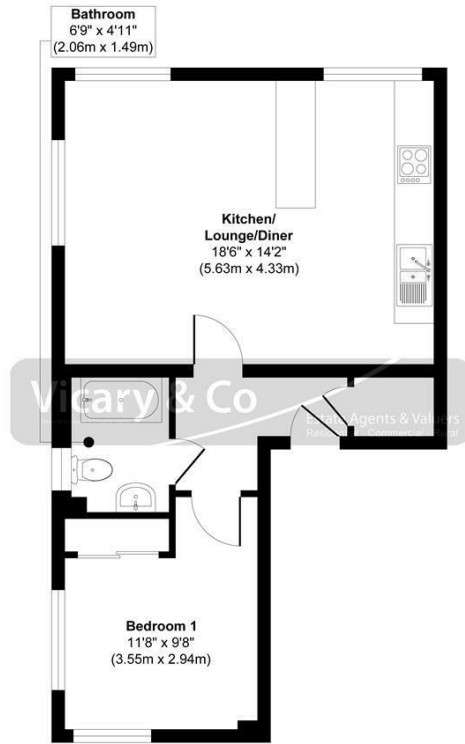

Floor Plan

Approx. Gross Internal Floor Area 470 sq. ft / 43.73 sq. m
Produced by Elements Property



Energy Efficiency Rating		
	Current	Potential
Very energy efficient - lower running costs		
(92 plus) A		
(81-91) B		
(69-80) C	75	76
(55-68) D		
(39-54) E		
(21-38) F		
(1-20) G		
Not energy efficient - higher running costs		
England & Wales	EU Directive 2002/91/EC	

Agents Note: Whilst every care has been taken to prepare these particulars, they are for guidance purposes only. All measurements are approximate and are for general guidance purposes only and whilst every care has been taken to ensure their accuracy, they should not be relied upon and potential buyers/tenants are advised to recheck the measurements

Head Office Sales
38 South Street
Bridport
Dorset
DT6 3NN

01308 459550
info@vicaryandco.com
<http://www.vicaryandco.com>

